

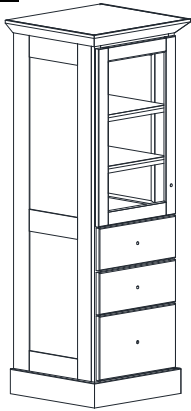

LINEN TOWERS CABINET SPECIFICATIONS

Premier Overlay Collections Ashford, Gentry, Lambiere, Yorkshire, and Zephyr



3D drawing shows hinge right. For hinge left, replace the "D" in position 7 of the model number with a "M".

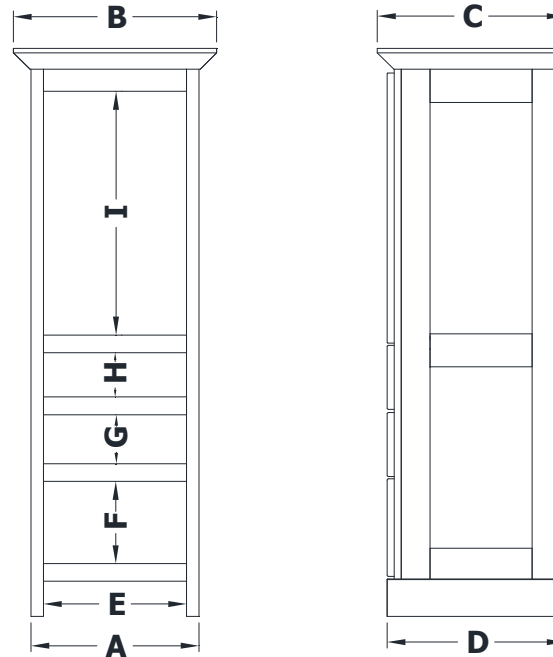

Cabinet height is 60 7/8". All dimensions are shown in inches rounded up or down to the nearest 1/8".

Available in 15" and 21" depth, depth does not include doors and drawer fronts which add 3/4".

For 15" or 21" deep models, place the "15" or 21" in positions 5-6 of the model number.

This model is standard with 2 adjustable shelves.

Model	A	B	C	D	E	F	G	H	I
FT1818D	18"	21 3/4"	20"	19"	15 1/4"	8 3/4"	5 1/4"	4 3/4"	26 1/8"