

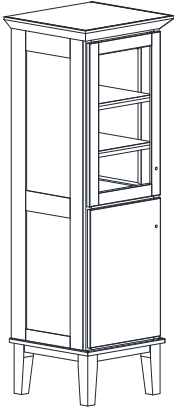

LINEN TOWERS WITH LEGS CABINET SPECIFICATIONS

Premier Overlay Collections

Ashford, Gentry, Lambiere, Yorkshire, and Zephyr



3D drawing shows drawers right. For drawers left, replace the "R" in position 7 of the model number with a "L".

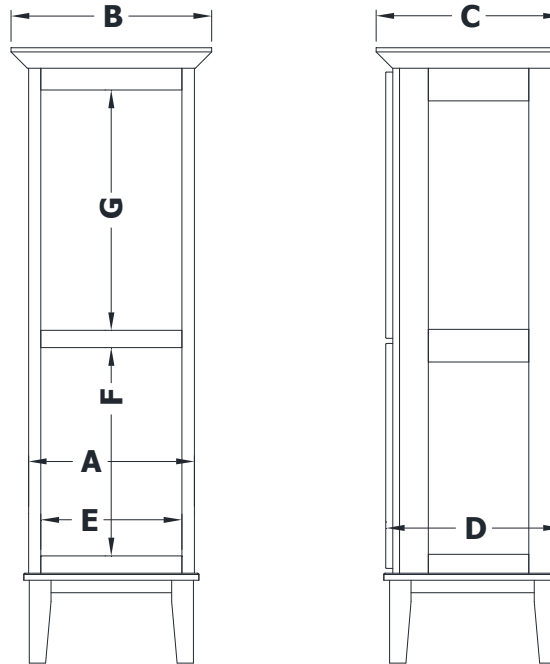

Cabinet height is 66 7/8". All dimensions are shown in inches rounded up or down to the nearest 1/8".

Available in 15" and 21" depth, depth does not include doors and drawer fronts which add 3/4".

For 15" or 21" deep models, place the "15" or 21" in positions 5-6 of the model number.

This model is standard with 3 adjustable shelves.

The sill adds 1" to the width and depth.

Model	A	B	C	D	E	F	G
DT1818L	18"	21 3/4"	20"	18 3/4"	15 1/4"	22 1/4"	26 1/8"